



TYPHOON PLUS

BEST PRACTICE

PIT STOP / GARAGE

Product name	TYPHOON PLUS
Product code	A.08.0024
Version	Cordless
Drive shaft	Spline
Weight (battery included)	3,5 kg (7.7 lbs)
Length	260 mm (10.23")
Width	84 mm (3.3")
Height	278 mm (10.94")
Voltage	20.0V d.c.
Free speed	1650 rpm
Max torque	1600 Nm (1180 ft-lbs) <i>Tests carried out on hub with M54x3 thread, friction coefficient <0.10 and nut/rim contact surface with 45° cone shape</i>
Amperage	6.0 Ah

ALSO AVAILABLE

Product name	TYPHOON PLUS
Drive shaft	SQUARE DRIVE
Product code	A.08.0026

AVAILABLE VERSIONS

UH Special unhandled version: loosens at same speed both the nuts tightened clockwise and anticlockwise

HIGHLIGHTS

- Fast, powerful and reliable
- Provided in a hard case
- Including: No. 2 Ultra Power batteries, a cable and a re-charger



SQUARE DRIVE READY

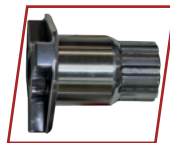

SPLINE ANVIL

Advantages:

- More efficient connection than traditional square drive anvil thanks to the elimination of gap and vibrations
- More durability due to less wear
- More comfort and safety for the operator thanks to the removal of the pin

A NEW PLAYER IN THE MOTORSPORT INDUSTRY!
LIGHTER AND FASTER THAN ANY COMPETITOR MODEL!

MOTORSPORT SOCKET CONNECTION

AEROSPACE ALUMINUM



ERGONOMIC HANDLE

LED LIGHT ON THE WORKING POINT DURING USE



BATTERY LEVEL INDICATOR

LITHIUM ION BATTERY 20.0 V D.C.

RAIN AND BATTERY COVER AVAILABLE!
SEE PAGE 113

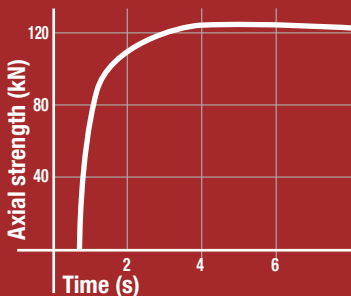

MANUAL



Operating and Maintenance Manual



WWW.PAOLI.NET | SALES@PAOLI.NET | +39.0522.364511