

NEW

HURRICANE 2.0 90° ANGLED HANDLE

BEST PRACTICE FORMULA 1 / INDYCAR

Product name	HURRICANE 2.0		
Handle Type	90° ANGLED HANDLE		
Front Cover Type	AEROSPACE 7075 ALUMINIUM ALLOY		
Product code LH Version	HURRICANE2.04	HURRICANE2.01	
Product code RH Version	2 port HURRICANE2.05	3 port	HURRICANE2.02
Product code UH Version	HURRICANE2.06	HURRICANE2.03	
Square drive	1"		
Weight	3,9 kg (8.59 lbs)		
Length	203 mm (7.99")		
Air inlet	3/8" BSP		
Supply hose inside diameter	13 mm (0.51")		
Max pressure	25 bar (362 psi)		
Free Speed (25 bar / 362 psi)	LH / RH 15000 rpm		UH 14800 rpm
Max torque	LH / RH 4300 Nm (3172 ft-lbs)		UH 4200 Nm (3100 ft-lbs)

AVAILABLE VERSIONS

LH Fast left hand version: loosens nuts tightened clockwise faster

RH Fast right hand version: loosens nuts tightened anticlockwise faster

UH Special unhandled version: loosens at same speed both the nuts tightened clockwise and anticlockwise

HIGHLIGHTS

- Increase robustness and reliability
- Faster at reaching the required tightening torque
- Electronic devices readiness

NEW RADIAL HAMMER MECHANISM (RHM) INSIDE!

The new radial hammer mechanism guarantees a superior performance and a longer lifespan of the hammer mechanism parts, thanks to the new developed geometry.



ALREADY INCLUDED!
TO INCREASE DURABILITY AND STRENGTH



E-SHUTTLE (ON DEMAND)

NEW OPTIONAL MONOLITHIC PIN

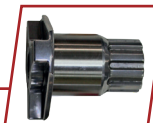

SPLINE DRIVE READY

COLOUR CODES

BUILT-IN FRS

COLOUR CODES

ERGONOMIC TRIGGER (ON DEMAND)

TIGHTENING

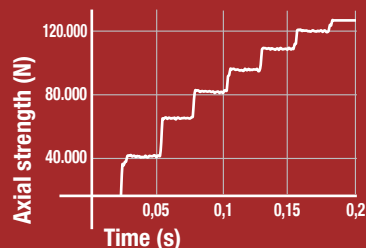

MANUAL



Operating and Maintenance Manual



WWW.PAOLI.NET | SALES@PAOLI.NET | +39.0522.364511