



# TYPHOON 1"

## BEST PRACTICE

PIT STOP / GARAGE

Product name	TYPHOON 1"
Product code	A.08.0014
Version	Cordless
Square drive	1"
Weight (with battery)	3,4 kg (7.5 lbs)
Length	260 mm (10.23")
Width	84 mm (3.3")
Height	278 mm (10.94")
Voltage	20.0V d.c.
Free speed	1650 rpm
Max torque	1600 Nm (1180 ft-lbs) <i>Tests carried out on hub with M54x3 thread, friction coefficient &lt;0.10 and nut/rim contact surface with 45° cone shape</i>
Amperage	6.0 Ah

## AVAILABLE VERSIONS



Special unhandled version: loosens at same speed both the nuts tightened clockwise and anticlockwise

## HIGHLIGHTS

- Fast, powerful and reliable
- Provided in a hard case
- Including: No. 2 Ultra Power batteries, a cable and a re-charger

NEW FLANGED SHAFT:  
MUCH MORE RELIABLE!

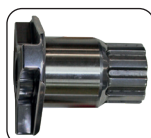

SPLINE DRIVE  
READY

MOTORSPORT SOCKET  
CONNECTION

AEROSPACE ALUMINUM

LED LIGHT ON THE WORKING  
POINT DURING USE

ERGONOMIC HANDLE

FAST  
BATTERY  
CHARGER



BATTERY LEVEL  
INDICATOR

LITHIUM ION BATTERY 20.0 V D.C.

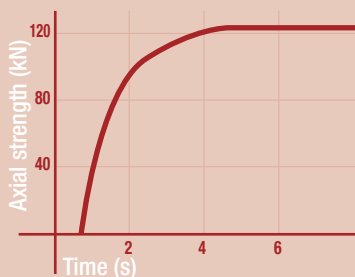

## MANUAL



Operating and  
Maintenance  
Manual



WWW.PAOLI.NET | SALES@PAOLI.NET | +39.0522.364511